**FAG****1202-TVH**

Self-aligning ball bearing

Self-aligning ball bearing 12...TVH, plastic cage

## Technical information

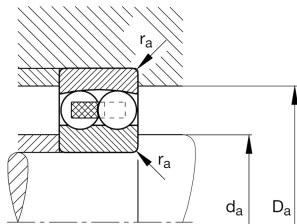
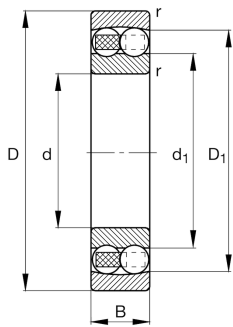

## Your current product variant

Bore type	Z	Cylindrical
Sealing	Without	Not sealed
Cage	TVH	Solid cage made of glass-fiber reinforced polyamid PA66
Tolerance class	PN	Normal (PN)
Lubricant	Without	Bearing not greased
Radial internal clearance	CN (Group N)	Normal internal clearance

## Main Dimensions &amp; Performance Data

d	15 mm	Bore diameter
D	35 mm	Outside diameter
B	11 mm	Width
C <sub>r</sub>	7,700 N	Basic dynamic load rating, radial
C <sub>0r</sub>	1,750 N	Basic static load rating, radial
C <sub>ur</sub>	111 N	Fatigue load limit, radial
n <sub>G</sub>	23,800 1/min	Limiting speed
n <sub>gr</sub>	19,100 1/min	Reference speed
≈m	0.047 kg	Weight

## Mounting dimensions

d <sub>a min</sub>	19.2 mm	Minimum diameter shaft shoulder
D <sub>a max</sub>	30.8 mm	Maximum diameter of housing shoulder
r <sub>a max</sub>	0.6 mm	Maximum fillet radius



Dimensions

$r_{min}$	0.6 mm	Minimum chamfer dimension
$D_1$	28.79 mm	Shoulder diameter outer ring
$d_1$	20.15 mm	Shoulder diameter inner ring









Temperature range

$T_{min}$	-30 °C	Operating temperature min.
$T_{max}$	120 °C	Operating temperature max.

Calculation factors

$e$	0.34	Limiting value of $F_a/F_r$ for the applicability of diff. Values of factors X and Y
$Y_1$	1.86	Dynamic axial load factor
$Y_2$	2.88	Dynamic axial load factor
$Y_0$	1.95	Static axial load factor

Characteristics

-  Radial load
-  Axial load in one direction
-  Axial load in two directions
-  Grease Lubrication
-  Oil Lubrication
-  Not sealed
-  Static angular error and misalignment
-  Dynamic angular error and misalignment